



HORIZONTAL FIXING KIT
KSFx50PL
INSTRUCTION MANUAL

The Sail Loft, Unit 16, Sandford Lane Industrial Estate, Wareham, Dorset BH20 4DY

Phone: +44 (0)1929 554308
www.shade-solutions.com



Email: info@kempsails.com
www.kempsails.com

HORIZONTAL FIXING KIT

An alternative tensioning solution for simplicity and ease of use. A great option if there is a larger gap between the post and the shade. Using 5m of braided rope spliced around a pair of blocks with carbine hooks for attachment at each end, the shade can be removed easily on a daily basis if required. Further flexibility which is worth considering allows the shade to be angled at different heights to suit the time of day; This can be achieved by adding extra eyebolts arranged at staggered heights on the post.

Please note post and wall anchor fittings are not included but can be purchased separately.

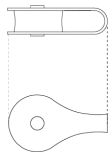

1 x Pulley Block 2 (*PLAIN BLOCK*)
KSFXTB2

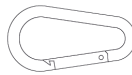

2 x Carbine Hook
KSF9060

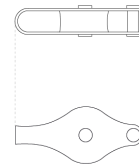

1 x Pulley Block 1 (*WITH BECKET*)
KSFXTB1

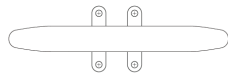

1 x Cross End Cleat
KSF414D



5m of 6mm Braided Rope
KSF5MWW

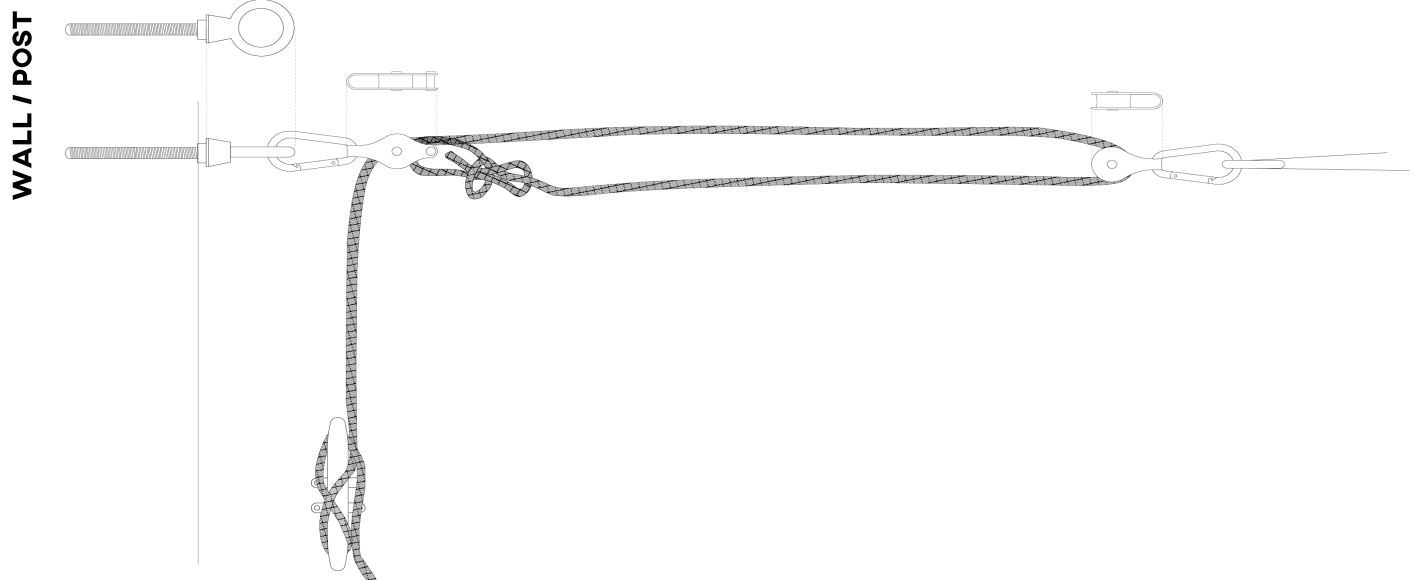

CORDLESS DRILL



HANDHELD PLIERS



SCREW DRIVER



- STEP 1 -

Attach 1 x Carbine Hook and 1 x Pulley Block 1
to anchor point

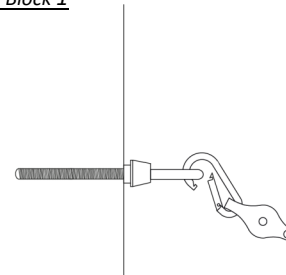
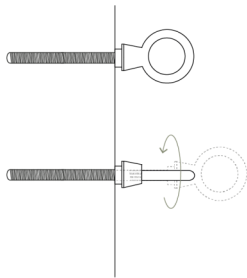

- STEP 2 -

Tie rope onto the becket of Pulley Block 1 (IDEALLY BOWLINE) and thread
loose tail through Pulley Block 2.

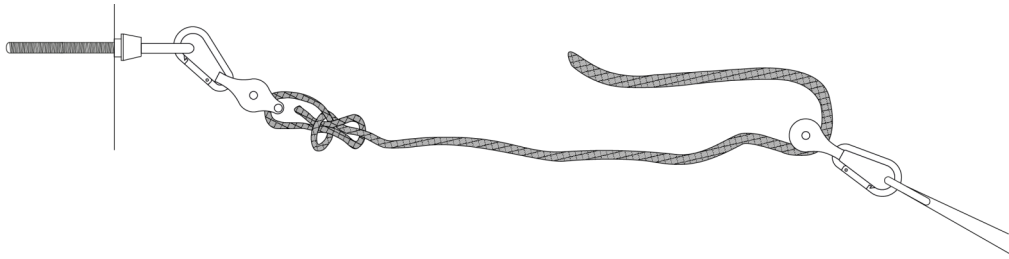

- STEP 3 -

Thread loose tail back through Pulley Block 1. Apply tension to the shade by pulling the rope
through the pulleys and tie off the rope around the Cross end Cleat fixed lower down on the post
or wall. Tension a little at a time working on each shade corner until even tension is gained all
round.

